

TO GO DEEPER INTO SPACE WE'LL NEED MORE POWER.

ROGER THAT TUCK. LET'S BUILD A SODA BOTTLE ROCKET!

I HAVE ALL THE MATERIALS READY TO GO.

LET'S DO IT!

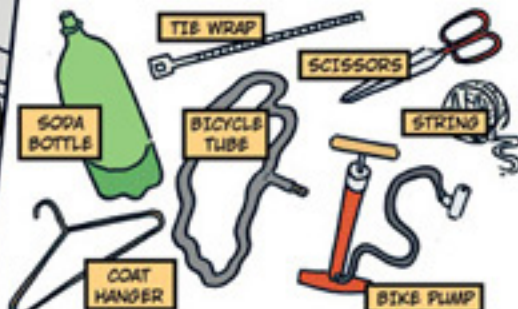

BLAST OFF!

CUT THE VALVE OFF THE TUBE. CUT IT AS LOW AS POSSIBLE.



WITH THE REMAINING TUBE CUT A LONG 1 INCH (2-3 CM) THICK STRIP.



WRAP THE STRIP AROUND THE VALVE.



TIE WRAP THE STRIP AROUND THE VALVE. MAKE IT NICE AND TIGHT.



FILL UP HALF OF BOTTLE.



CORK UP THE BOTTLE WITH THE WRAPPED VALVE.



TAKE THE COAT HANGER AND CUT AND BEND IT LIKE SO.

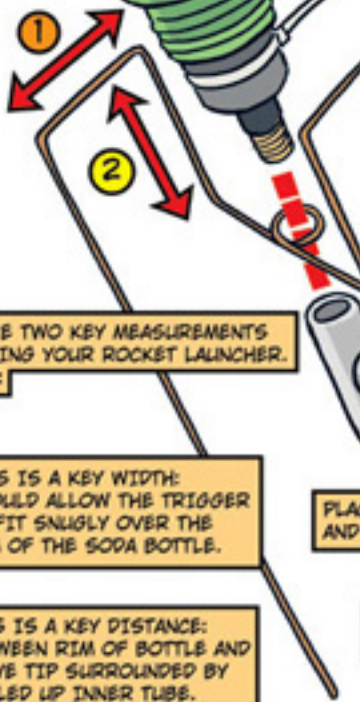

THERE ARE TWO KEY MEASUREMENTS IN BUILDING YOUR ROCKET LAUNCHER. THEY ARE:

1 THIS IS A KEY WIDTH: SHOULD ALLOW THE TRIGGER TO FIT SNUGLY OVER THE RIM OF THE SODA BOTTLE.

2 THIS IS A KEY DISTANCE: BETWEEN RIM OF BOTTLE AND VALVE TIP SURROUNDED BY ROLLED UP INNER TUBE.

TRIGGER MECHANISM HOLDS PRESSURE VALVE TOGETHER WITH RIM OF BOTTLE AS THE AIR IS PUMPED IN. BY YANKING ON THE TRIGGER THE WATER INSIDE IS ABLE TO SPIT OUT THE PRESSURE VALVE AND LAUNCH THE ROCKET.

USE STRING TO YANK OUT TRIGGER.

WHEN YOU ARE READY TO LAUNCH PUT ON YOUR SAFETY MASK AND STAND AWAY FROM THE LAUNCHER. PUMP TO PRESSURIZE ROCKET THEN PULL OUT THE TRIGGER.

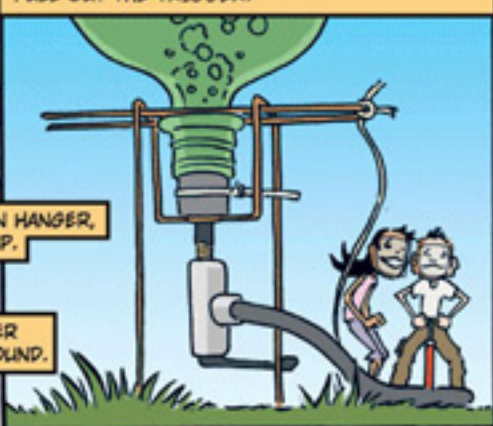

PLACE VALVE THRU LOOP IN HANGER, AND CONNECT TO BIKE PUMP.

PLACE ENDS OF HANGER FIRMLY INTO THE GROUND.

HOW HIGH CAN YOU GO? TRY USING MORE OR LESS WATER.

CHECK OUT THE SODA BOTTLE ROCKET VIDEO! AT HOWTOONS.COM